

461&463 Sterling Place

Prospect Heights

Two Spaces for Lease

550 + 550 SF



SUMMARY

This property offers a unique and efficient neighborhood opportunity considering its proximity to the Brooklyn Museum and Prospect Park. Two 550 SF spaces on the Prospect Heights border make this well positioned on the corner of Washington and Sterling Avenues. These spaces are ideal for a professional office, tattoo parlor, barber shop or café.

HIGHLIGHTS

- High ceilings
- Double wide sidewalks
- Central HVAC installed
- Washington Ave visibility

LEASABLE AREA

(2x) 550 SF spaces

CEILING HEIGHTS

11 ft

CROSS STREETS

Corner of Sterling Avenue

PRICING & TERMS

Upon request

AVAILABILITY

Immediate

TRANSPORTATION



NEIGHBORING TENANTS



For more information, contact exclusive agents:

Peter Schubert
 Managing Director
 pschubert@terracr.com

Abbie Cheng
 Associate
 acheng@terracr.com

George Hewitt
 Associate
 ghewitt@terracr.com

(718) 768-7788
 terracr.com



461&463 Sterling Place

Prospect Heights

Two Spaces for Lease

550 + 550 SF

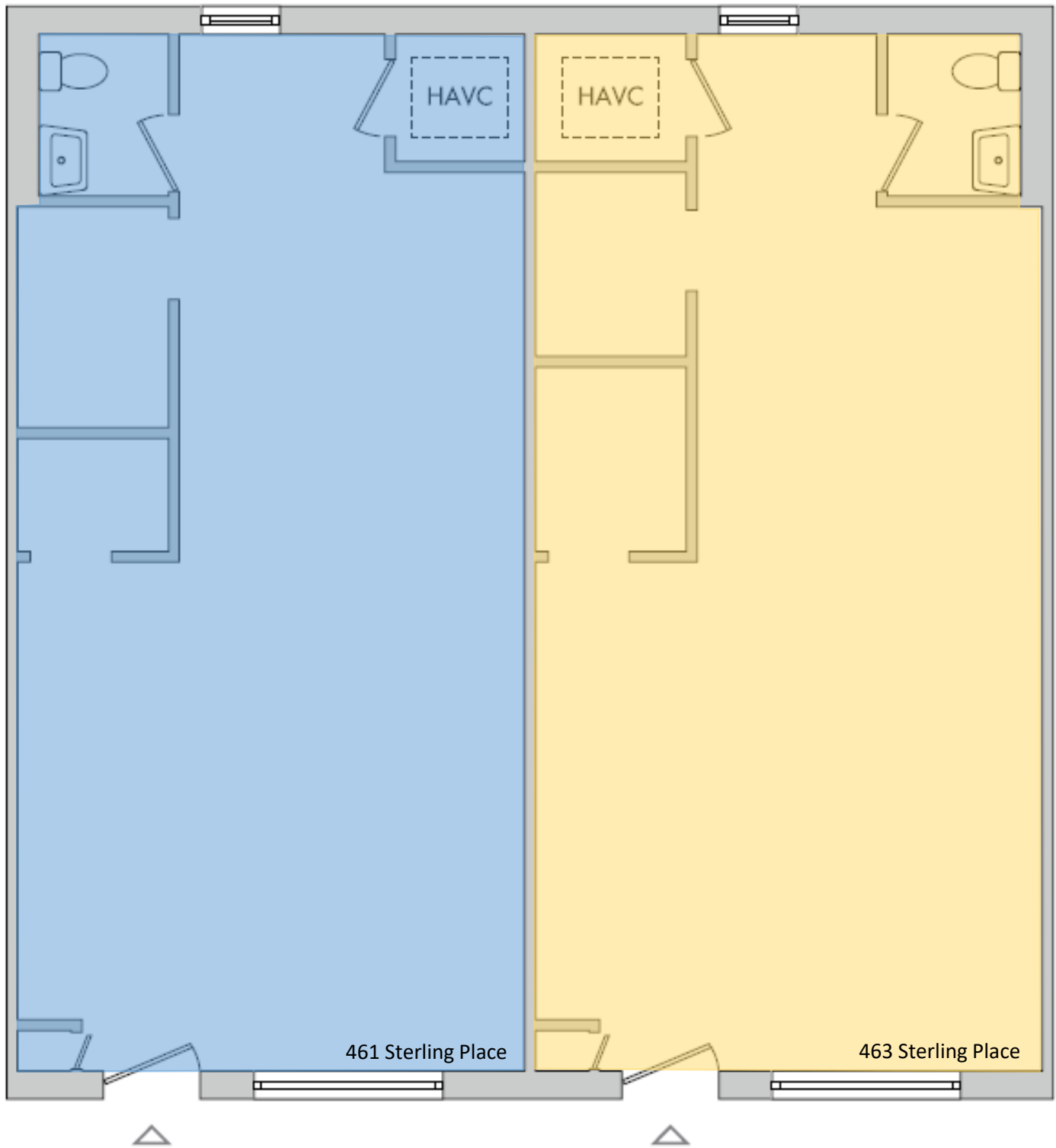

For more information, contact exclusive agents:

Peter Schubert
Managing Director
pschubert@terracrgr.com

Abbie Cheng
Associate
acheng@terracrgr.com

George Hewitt
Associate
ghewitt@terracrgr.com

(718) 768-7788
terracrgr.com