



## 7 Bell Slip

**Space A - 1,520 SF**  
**80 feet of frontage**  
**17 foot ceiling heights**

Space A at 7 Bell Slip benefits from excellent corner visibility and dramatic ceiling heights at the intersection of Franklin and Commercial Streets. The space features two sets of double glass doors, a built ADA bathroom and storage. Delivery to tenant as a clean white box with smooth concrete floors with 200 amps/ 3-phase power.

### The Retail at Greenpoint Landing

In total the five retail spaces represent the first and some of the best retail offerings at Greenpoint Landing. Each of the retail spaces offers high, open ceilings, large wraparound windows, high amperage, ADA bathrooms, and direct metering. Please inquire for pricing and detailed floor plans.

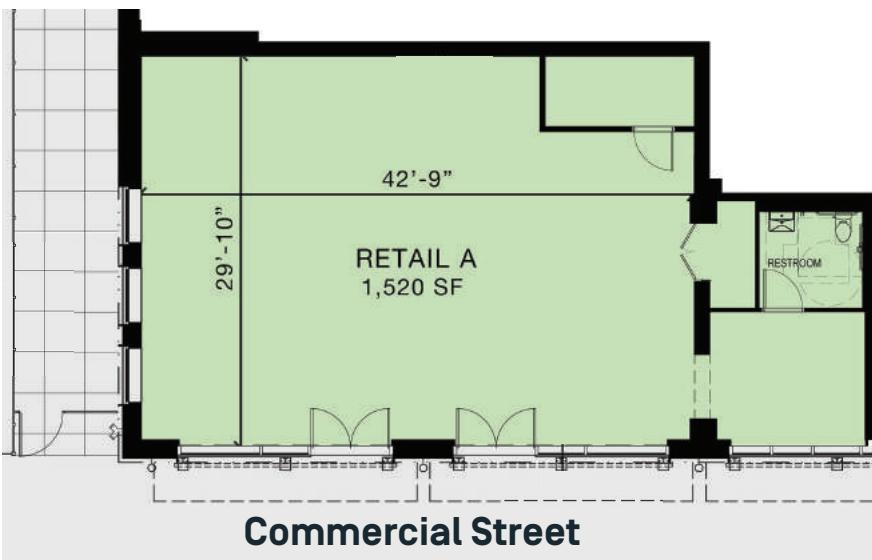

### Greenpoint Landing

Greenpoint Landing is an exciting mixed-use development located along the waterfront in Greenpoint. The project will transform a half-mile, 22-acre stretch along the East River and open up access to the water. With a total of 5,500 planned units, Greenpoint Landing will bring substantial new residents, open space and neighborhood retail to the existing community.

To learn more about this opportunity please contact exclusive agents:

**ABBIE CHENG**  
[ACHENG@TERRACRG.COM](mailto:ACHENG@TERRACRG.COM)

**PETER SCHUBERT**  
[PSCHUBERT@TERRACRG.COM](mailto:PSCHUBERT@TERRACRG.COM)