

RESTORATION PLAZA RETAIL



1396 FULTON STREET | 1,511 SF

TERRACRG
COMMERCIAL REALTY GROUP



HIGHLIGHTS

High traffic corridor
Excellent transportation
Institutional landlord
Wide frontage

NEIGHBORHOOD

Bedford-Stuyvesant

CROSS STREETS

New York & Brooklyn Avenues

LEASABLE AREA

1,511 SF Ground Level

FRONTAGE

36 feet

CEILING HEIGHT

10 feet

ASKING PRICE

Upon Request

NEIGHBORING RETAIL

Carver Bank
Citibank
Chase Bank
Foodtown Supermarket
TD Bank (Coming soon)
Blink Fitness (Coming soon)

TRANSPORTATION

A C at Nostrand Ave.

Annual Ridership
5,439,806

For more information, contact exclusive agents:

Peter Schubert
Managing Director
pschubert@terraccrg.com

Joseph Terzi
Associate
jterzi@terraccrg.com

Lauren Musacchio
Associate
lmusacchio@terraccrg.com

(718) 768-7788
terraccrg.com

RESTORATION PLAZA RETAIL

1396 FULTON STREET | 1,511 SF



TERRACRG
COMMERCIAL REALTY GROUP

FLOOR PLAN

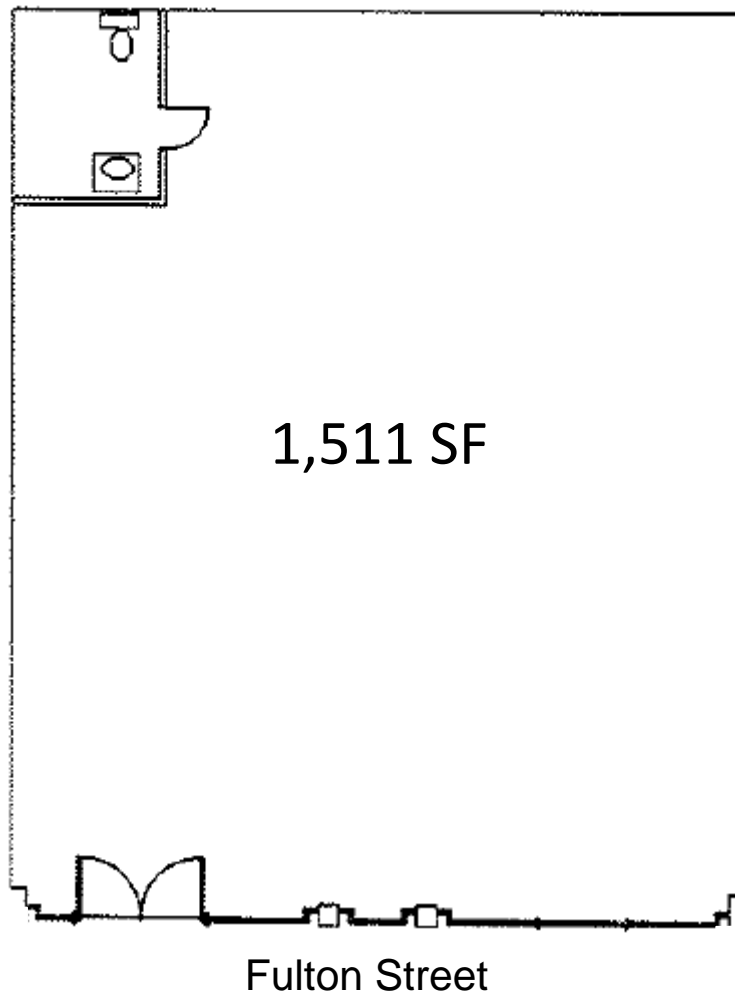

The information provided herein has either been given to us by the owner of the property or was obtained from sources we deem reliable. We do not guarantee the accuracy of any information. All zoning, existing square feet of buildings, available buildable square feet, permitted uses and any other information provided herein must be independently verified. The value of any real estate investment is dependent upon a variety of factors including income, vacancy rates, expense estimates, tax brackets and general market assumptions, all of which should be evaluated by your tax advisor and/or legal counsel. Prospective buyer and tenants should carefully verify each item of information herein.

For more information, contact exclusive agents:

Peter Schubert
Managing Director
pschubert@terracrg.com

Joseph Terzi
Associate
jterzi@terracrg.com

Lauren Musacchio
Associate
lmusacchio@terracrg.com

(718) 768-7788
terracrg.com